



  
**J.L. Richards**  
 ENGINEERS-ARCHITECTS-PLANNERS  
**J.L. Richards & Associates Limited**  
 700 - 1565 CARLING AVENUE  
 Ottawa, ON Canada  
 K1Z 8R1  
 Tel: 613 728 3571  
 Fax: 613 728 6012



GEORGIAN ROAD



PRINCE EDWARD ROAD



NORMAN ROAD

ICIP SIDEWALK PROGRAM GEORGIAN, PRINCE EDWARD & NORMAN ROAD	
Sheet Number	Sheet Title
CS	Cover Sheet
C01	Georgian General Plan
C02	Georgian Plan and Profile
C03	Georgian Plan and Profile
C04	Georgian Typical Cross Sections_Phase 2
C05	Georgian Road Details
C06	Prince Edward General Plan
C07	Prince Edward Plan and Profile
C08	Prince Edward Plan and Profile
C09	Prince Edward Plan and Profile
C10	Prince Edward Plan and Profile
C11	Prince Edward Plan and Profile
C12	Prince Edward Plan and Profile
C13	Prince Edward Typical Cross Sections
C14	Prince Edward Details
C15	Norman General Plan
C16	Norman Plan and Profile
C17	Norman Plan and Profile
C18	Norman Typical Cross Sections
C19	Norman Details

# CITY OF NORTH BAY ICIP SIDEWALK PROGRAM

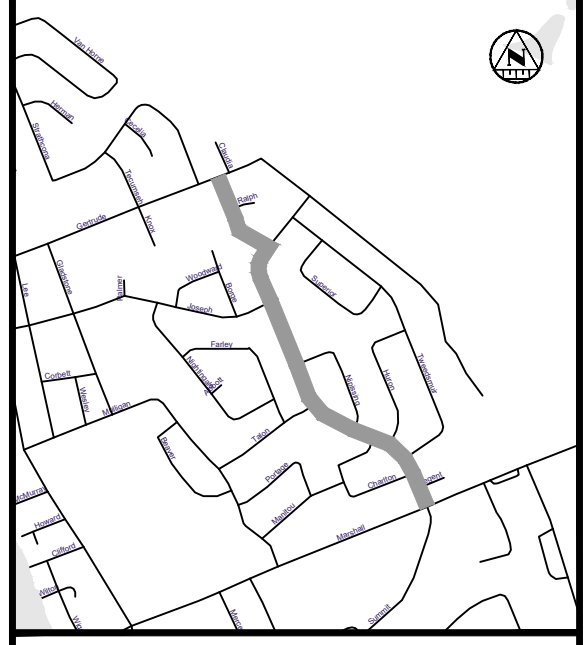
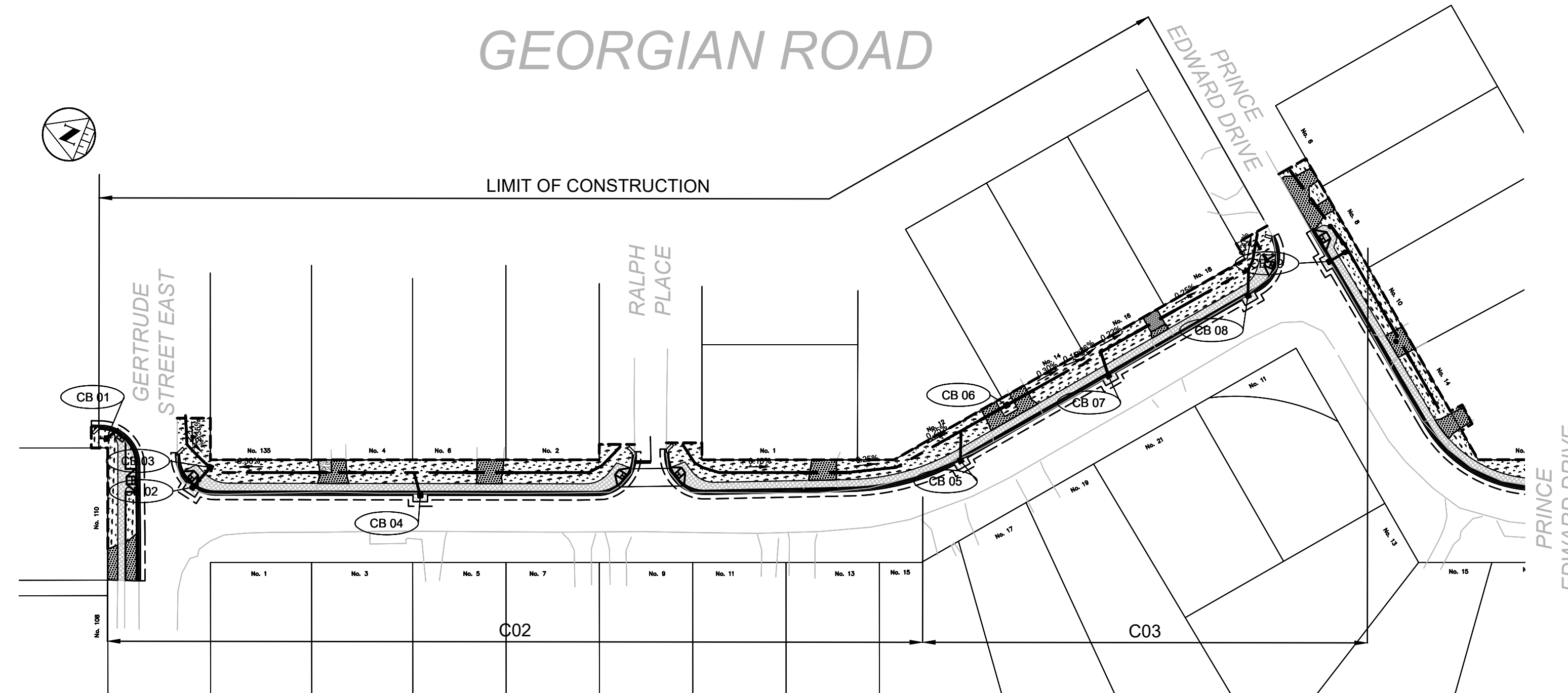

KEY PLAN

LEGEND

- PROPOSED**
- STORM PIPE
  - PROPOSED DITCH CENTERLINE
  - PERFORATED PIPE
  - CATCH BASIN AS PER OPSD 705.010
  - STORM MAINTENANCE HOLE AS PER OPSD 701.010
  - CATCH BASIN MAINTENANCE HOLE AS PER OPSD 701.010
  - CURB & GUTTER WITH DEPRESSED CURB
  - FULL DEPTH ROAD CUT WITH TOP LIFT MILLING
  - CONCRETE SIDEWALK
  - LIMIT OF GRADING
  - TACTILE WALKING SURFACE INDICATOR (TWSI)
- EXISTING**
- BELL-BELL
  - EXISTING HYDRO
  - EXISTING GAS
  - EX. 200mm Ø SAN
  - EX. 150mm Ø SAN
  - EX. WATERMAIN & VALVE
  - LOT/CONCESSION LINES
  - EX. MAINTENANCE HOLE
  - EDGE OF PAVEMENT
  - HYDRO POLE/LIGHT
  - EXISTING DITCH

REVISIONS

No.	Date	By	Description
1	OCT 05 2021	AT	ISSUED FOR 30% DESIGN
2	DEC 23 2021	CL	ISSUED FOR 60% DESIGN
3	APR 29 2022	CL	ISSUED FOR 90% DESIGN
4	DEC 09 2022	CL	ISSUED FOR CLIENT REVIEW
5	DEC 16 2022	CL	ISSUED FOR TENDER
6	JAN 13 2023	CL	RE-ISSUED FOR TENDER



CITY OF NORTH BAY  
ICIP SIDEWALK  
PROGRAM

NEW CONSTRUCTION

Georgian Road  
General Plan

Designer: A.Y. / C.B.	Checked by: D.L.
Date: 12/01/2021	Approved by: C.L.

Scale:  
1:750 - GEORGIAN ROAD

Drawing Number: C01	Drawing Set: 01 of 19
------------------------	--------------------------

CONSTRUCTION NOTES:

1. THE LOCATION OF THE UTILITIES IS APPROXIMATE ONLY. THE EXACT LOCATION SHOULD BE DETERMINED BY CONSULTING THE MUNICIPAL AUTHORITIES AND UTILITY COMPANIES CONCERNED. THE CONTRACTOR SHALL PROVE THE LOCATION OF UTILITIES AND SHALL BE RESPONSIBLE FOR ADEQUATE PROTECTION FROM DAMAGE.
2. ALL DIMENSIONS ARE IN METERS UNLESS OTHERWISE NOTED.
3. WITH THE EXCEPTION OF THE CITY OF NORTH BAY CONSTRUCTION SPECIFICATIONS & STANDARD DETAIL DRAWINGS REFERRED TO IN THIS CONTRACT, ONTARIO PROVINCIAL STANDARD DRAWINGS (OPSD) & STANDARD SPECIFICATIONS (OPSS) SHALL APPLY TO THIS CONTRACT.
4. ALL BASE MAPPING IS REFERENCED TO NORTH AMERICAN DATUM OF 1983 (NAD83)
5. ALL DISTURBED AREAS (SIDEWALK, PAVEMENT, CURB, SOD, ETC.) TO BE REINSTATED TO EXISTING CONDITIONS OR BETTER PER CITY OF NORTH BAY STANDARDS.
6. REFER TO GEOTECHNICAL REPORT. SOIL INFORMATION SHOWN IS NOT GUARANTEED AND CONTRACTORS ARE ADVISED TO COLLECT ADDITIONAL SOILS INFORMATION AS DEEMED NECESSARY.
7. CONTRACTOR TO ADVISE CONTRACT ADMINISTRATOR IMMEDIATELY OF ANY KNOWN CONFLICTS WITH TREES AND/OR EXISTING UTILITIES.
8. THE CONTRACTOR SHALL REMOVE, SALVAGE AND STORE IN SAFE AREA ALL EXISTING SIGNAGE IMPACTED BY WORK. REINSTATE ALL SIGNAGE AS PART OF WORK.
9. THE CONTRACTOR IS RESPONSIBLE FOR PROVIDING PROTECTION FOR ALL EXISTING UNDERGROUND AND ABOVE GROUND UTILITIES DURING CONSTRUCTION.
10. THE REINSTATEMENT DRAWINGS ARE APPROXIMATE ONLY AND ARE BASED ON SURVEY AND BASE MAPPING INFORMATION, WHICH MAY NOT INCLUDE ALL LANDSCAPING FEATURES AND DETAILS. SOME LANDSCAPING FEATURES MAY ALSO HAVE BEEN CHANGED BY HOMEOWNERS SINCE THE SURVEY WAS COMPLETED. THE CONTRACTOR SHALL BE SOLELY RESPONSIBLE FOR THE DOCUMENTS PHOTOGRAPHING THE PRE-CONSTRUCTION CONDITIONS AND LANDSCAPING AT EACH PROPERTY PRIOR TO CARRYING OUT ANY REMOVALS. REINSTATEMENT SHALL MATCH THE PRE-CONSTRUCTION CONDITIONS UNLESS DIRECTED OTHERWISE BY THE CONTRACT ADMINISTRATOR.
11. EXISTING UNDERGROUND UTILITIES AND SERVICES DEPICTED ON THE DRAWINGS REPRESENT LOCATIONS IDENTIFIED ON THE CITY'S RECORD DRAWINGS. NOT ALL EXISTING UNDERGROUND UTILITIES AND SERVICES ARE DEPICTED ON THESE DRAWINGS. NO REPRESENTATION AS TO THE DEPTH OF ALL UTILITIES AND SERVICES IS MADE.
12. CONTRACTOR TO MAINTAIN ACCESS AT ALL TIMES TO ALL MH'S, VALVE BOXES AND VALVE CHAMBERS.
13. CONTRACTOR SHALL EXCAVATE NEAR AND TEMPORARILY SUPPORT EXISTING UTILITIES IN ACCORDANCE WITH THEIR THIRD-PARTY REQUIREMENTS. THE USE OF HYDRO-EXCAVATION IN THE VICINITY OF EXCAVATION AND TREES IS INCLUSIVE TO THE EXCAVATION WORK.
14. CONTRACTOR TO CONFIRM ALL PROPOSED STORM AND DITCH OUTLET ELEVATIONS AT THE ONSET OF CONSTRUCTION. NOTIFY THE CA OF ANY DISCREPANCIES.

- CONSTRUCTION NOTES:**
- CONTRACTOR TO CONFIRM ALL GRADES AND TIE-IN POINTS PRIOR TO CONSTRUCTING NEW SIDEWALKS.
  - REINSTATE GRASSED AREAS WITH 100MM OF TOPSOIL AND No.1 NURSERY SOD.
  - PROTECT ALL UTILITIES INCLUDING UTILITY POLES.
  - ALL TREES ARE TO BE PROTECTED.
  - SAW CUT ASPHALT TO PROVIDE CLEAN LINES PRIOR TO REINSTATEMENT. PROVIDE 300MM WIDE STEP JOINT (400MM DEEP). TREAT ALL CUT FACES WITH TACK COAT BEFORE PLACING NEW ASPHALT.
  - WHERE APPLICABLE, REMOVE AND SALVAGE INTERLOCKING BRICK PAVERS AS REQUIRED FOR CONSTRUCTION OF NEW SIDEWALK.
  - ASPHALT DRIVEWAY REINSTATEMENT TO BE MINIMUM:
    - 250MM THICK GRANULAR 'A'
    - 50MM THICK HL3F MIX WITH PGAC - 58-34
  - GRANULAR DRIVEWAY REINSTATEMENT TO BE MINIMUM 250MM GRANULAR 'A'.
  - THE UTILITIES INFORMATION CONTAINED ON THIS DRAWING MAY BE BASED UPON DATA PROVIDED BY OTHERS AND MAY NOT HAVE BEEN VERIFIED BY EITHER AS-CONSTRUCTED DRAWINGS OR AN ONTARIO LAND SURVEYOR. THE CITY OF NORTH BAY CANNOT ACCEPT RESPONSIBILITY FOR ERRORS OR OMISSIONS ON ANY INFORMATION SHOWN HEREIN. FIELD VERIFICATION, LAND SURVEYS OR EXCAVATION (WITH CITY APPROVALS) MAY BE REQUIRED TO DETERMINE ACTUAL LOCATION OF ANY AND ALL UTILITIES OR PROPERTY LINES.
  - 3H:1V DITCH SIDE SLOPE TYPICAL. 2H:1V DITCH SIDE SLOPE TO ONLY BE USED LOCALLY WHERE EXISTING FEATURES (IE, TREES, UTILITY POLES, HYDRANTS) WARRANT IT.

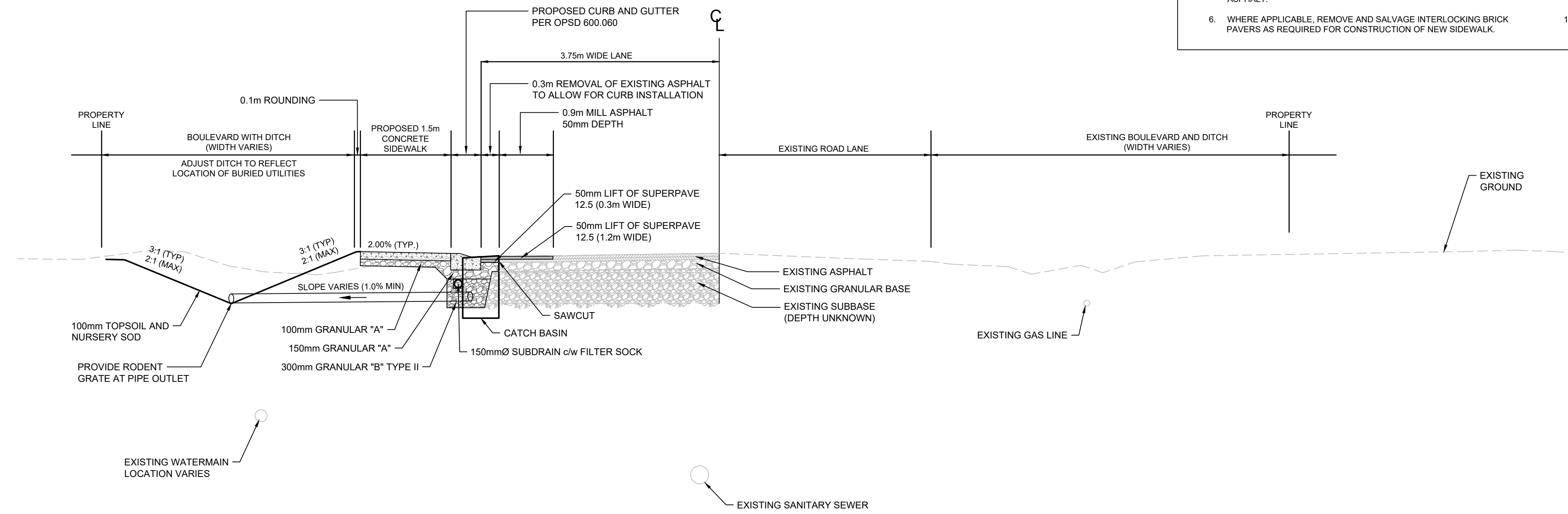

**GEORGIAN ROAD  
TYPICAL CROSS SECTION**

STA. 4+185 SCALE: 1:50

**KEY PLAN**

**LEGEND**

**PROPOSED**

- 375mm Ø ST - STORM PIPE
- PROPOSED DITCH CENTERLINE
- PERFORATED PIPE
- CATCH BASIN AS PER OPSD 705.010
- STORM MAINTENANCE HOLE AS PER OPSD 701.010
- CATCH BASIN MAINTENANCE HOLE AS PER OPSD 701.010
- CURB & GUTTER WITH DEPRESSED CURB
- FULL DEPTH ROAD CUT WITH TOP LIFT MILLING
- LIMIT OF GRADING
- CONCRETE SIDEWALK
- TACTILE WALKING SURFACE INDICATOR (TWSI)

**EXISTING**

- BELL-BELL - EXISTING BELL
- H-H - EXISTING HYDRO
- G-G - EXISTING GAS
- EX. 200mm Ø SAN - EXISTING SANITARY PIPE
- EX. 305mm Ø VAL - EX. WATERMAIN & VALVE
- LOT/CONCESSION LINES
- EX. MAINTENANCE HOLE
- EDGE OF PAVEMENT
- HYDRO POLE/LIGHT
- EXISTING DITCH

**REVISIONS**

No.	Date	By	Description
1	OCT 05 2021	AT	ISSUED FOR 30% DESIGN
2	DEC 23 2021	CL	ISSUED FOR 60% DESIGN
3	APR 29 2022	CL	ISSUED FOR 90% DESIGN
4	DEC 09 2022	CL	ISSUED FOR CLIENT REVIEW
5	DEC 16 2022	CL	ISSUED FOR TENDER
6	JAN 13 2023	CL	RE-ISSUED FOR TENDER



**CITY OF NORTH BAY  
ICIP SIDEWALK  
PROGRAM**

**NEW CONSTRUCTION**

**GEORGIAN ROAD  
TYPICAL CROSS  
SECTIONS**

Designer: A.Y. / C.B.	Checked by: D.L.
Date: 12/01/2021	Approved by: C.L.

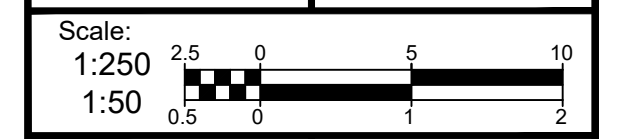

Drawing Number: **C04** Drawing Set: **04 of 19**

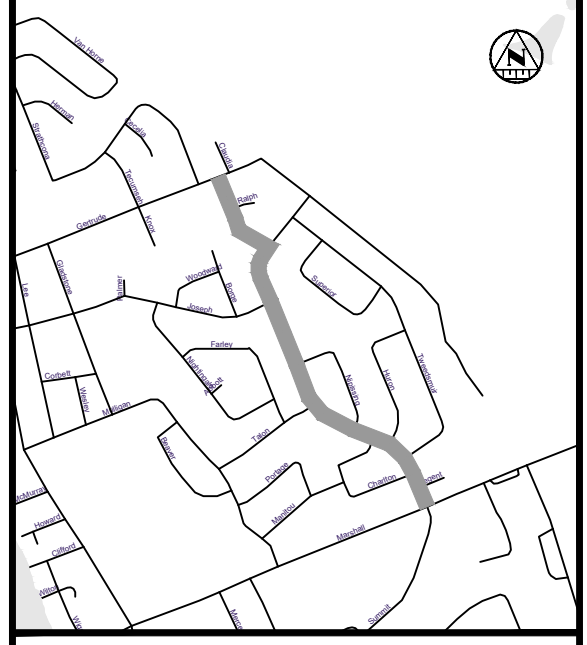

KEY PLAN

LEGEND

- PROPOSED**
- 375mm Ø ST STORM PIPE
  - PROPOSED DITCH CENTERLINE
  - PERFORATED PIPE
  - CATCH BASIN AS PER OPSD 705.010
  - STORM MAINTENANCE HOLE AS PER OPSD 701.010
  - CATCH BASIN MAINTENANCE HOLE AS PER OPSD 701.010
  - CURB & GUTTER WITH DEPRESSED CURB
  - FULL DEPTH ROAD CUT WITH TOP LIFT MILLING
  - CONCRETE SIDEWALK
  - LIMIT OF GRADING
  - TACTILE WALKING SURFACE INDICATOR (TWSI)
- EXISTING**
- EXISTING BELL
  - EXISTING HYDRO
  - EXISTING GAS
  - EXISTING SANITARY PIPE
  - EX. WATERMAIN & VALVE
  - LOT/CONCESSION LINES
  - EX. MAINTENANCE HOLE
  - EDGE OF PAVEMENT
  - HYDRO POLE/LIGHT
  - EXISTING DITCH

REVISIONS

No.	Date	By	Description
1	OCT 05 2021	AT	ISSUED FOR 30% DESIGN
2	DEC 23 2021	CL	ISSUED FOR 60% DESIGN
3	APR 29 2022	CL	ISSUED FOR 90% DESIGN
4	DEC 09 2022	CL	ISSUED FOR CLIENT REVIEW
5	DEC 16 2022	CL	ISSUED FOR TENDER
6	JAN 13 2023	CL	RE-ISSUED FOR TENDER



CITY OF NORTH BAY  
ICIP SIDEWALK  
PROGRAM

NEW CONSTRUCTION

Prince Edward Drive  
General Plan

Designer: A.Y. / C.B.	Checked by: D.L.
Date: 12/01/2021	Approved by: C.L.

Scale:  
1:1250 - PRINCE EDWARD DRIVE

Drawing Number: C06	Drawing Set: 06 of 19
------------------------	--------------------------

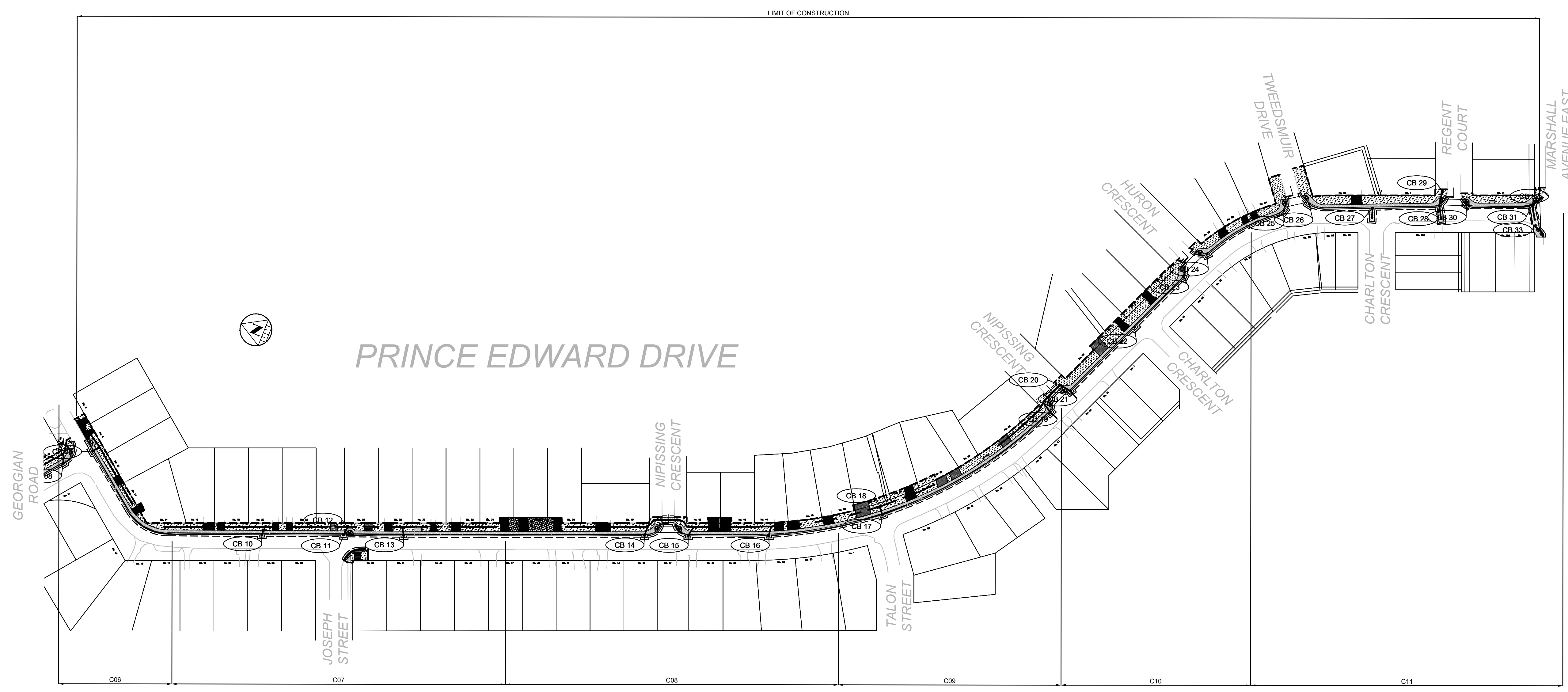

- CONSTRUCTION NOTES:**
- THE LOCATION OF THE UTILITIES IS APPROXIMATE ONLY. THE EXACT LOCATION SHOULD BE DETERMINED BY CONSULTING THE MUNICIPAL AUTHORITIES AND UTILITY COMPANIES CONCERNED. THE CONTRACTOR SHALL PROVE THE LOCATION OF UTILITIES AND SHALL BE RESPONSIBLE FOR ADEQUATE PROTECTION FROM DAMAGE.
  - ALL DIMENSIONS ARE IN METERS UNLESS OTHERWISE NOTED.
  - WITH THE EXCEPTION OF THE CITY OF NORTH BAY CONSTRUCTION SPECIFICATIONS & STANDARD DETAIL DRAWINGS REFERRED TO IN THIS CONTRACT, ONTARIO PROVINCIAL STANDARD DRAWINGS (OPSD) & STANDARD SPECIFICATIONS (OPSS) SHALL APPLY TO THIS CONTRACT.
  - ALL BASE MAPPING IS REFERENCED TO NORTH AMERICAN DATUM OF 1983 (NAD83)
  - ALL DISTURBED AREAS (SIDEWALK, PAVEMENT, CURB, SOD, ETC.) TO BE REINSTATED TO EXISTING CONDITIONS OR BETTER PER CITY OF NORTH BAY STANDARDS.
  - REFER TO GEOTECHNICAL REPORT. SOIL INFORMATION SHOWN IS NOT GUARANTEED AND CONTRACTORS ARE ADVISED TO COLLECT ADDITIONAL SOILS INFORMATION AS DEEMED NECESSARY.
  - CONTRACTOR TO ADVISE CONTRACT ADMINISTRATOR IMMEDIATELY OF ANY KNOWN CONFLICTS WITH TREES AND/OR EXISTING UTILITIES.
  - THE CONTRACTOR SHALL REMOVE, SALVAGE AND STORE IN SAFE AREA ALL EXISTING SIGNAGE IMPACTED BY WORK. REINSTATE ALL SIGNAGE AS PART OF WORK.
  - THE CONTRACTOR IS RESPONSIBLE FOR PROVIDING PROTECTION FOR ALL EXISTING UNDERGROUND AND ABOVE GROUND UTILITIES DURING CONSTRUCTION.
  - THE REINSTATEMENT DRAWINGS ARE APPROXIMATE ONLY AND ARE BASED ON SURVEY AND BASE MAPPING INFORMATION, WHICH MAY NOT INCLUDE ALL LANDSCAPING FEATURES AND DETAILS. SOME LANDSCAPING FEATURES MAY ALSO HAVE BEEN CHANGED BY HOMEOWNERS SINCE THE SURVEY WAS COMPLETED. THE CONTRACTOR SHALL BE SOLELY RESPONSIBLE FOR THE DOCUMENTS PHOTOGRAPHING THE PRE-CONSTRUCTION CONDITIONS AND LANDSCAPING AT EACH PROPERTY PRIOR TO CARRYING OUT ANY REMOVALS. REINSTATEMENT SHALL MATCH THE PRE-CONSTRUCTION CONDITIONS UNLESS DIRECTED OTHERWISE BY THE CONTRACT ADMINISTRATOR.
  - EXISTING UNDERGROUND UTILITIES AND SERVICES DEPICTED ON THE DRAWINGS REPRESENT LOCATIONS IDENTIFIED ON THE CITY'S RECORD DRAWINGS. NOT ALL EXISTING UNDERGROUND UTILITIES AND SERVICES ARE DEPICTED ON THESE DRAWINGS. NO REPRESENTATION AS TO THE DEPTH OF ALL UTILITIES AND SERVICES IS MADE.
  - CONTRACTOR TO MAINTAIN ACCESS AT ALL TIMES TO ALL MHS, VALVE BOXES AND VALVE CHAMBERS.
  - CONTRACTOR SHALL EXCAVATE NEAR AND TEMPORARILY SUPPORT EXISTING UTILITIES IN ACCORDANCE WITH THEIR THIRD-PARTY REQUIREMENTS. THE USE OF HYDRO-EXCAVATION IN THE VICINITY OF EXCAVATION AND TREES IS INCLUSIVE TO THE EXCAVATION WORK.
  - CONTRACTOR TO CONFIRM ALL PROPOSED STORM AND DITCH OUTLET ELEVATIONS AT THE ONSET OF CONSTRUCTION. NOTIFY THE CA OF ANY DISCREPANCIES.

- CONSTRUCTION NOTES:**
- CONTRACTOR TO CONFIRM ALL GRADES AND TIE-IN POINTS PRIOR TO CONSTRUCTING NEW SIDEWALKS.
  - REINSTATE GRASSED AREAS WITH 100MM OF TOPSOIL AND No. 1 NURSERY SOD.
  - PROTECT ALL UTILITIES INCLUDING UTILITY POLES.
  - ALL TREES ARE TO BE PROTECTED.
  - SAW CUT ASPHALT TO PROVIDE CLEAN LINES PRIOR TO REINSTATEMENT. PROVIDE 300MM WIDE STEP JOINT (400MM DEEP). TREAT ALL CUT FACES WITH TACK COAT BEFORE PLACING NEW ASPHALT.
  - WHERE APPLICABLE, REMOVE AND SALVAGE INTERLOCKING BRICK PAVERS AS REQUIRED FOR CONSTRUCTION OF NEW SIDEWALK.
  - ASPHALT DRIVEWAY REINSTATEMENT TO BE MINIMUM:
    - 250MM THICK GRANULAR 'A'
    - 50MM THICK HL3F MIX WITH PGAC - 58-34
  - GRANULAR DRIVEWAY REINSTATEMENT TO BE MINIMUM 250MM GRANULAR 'A'.
  - THE UTILITIES INFORMATION CONTAINED ON THIS DRAWING MAY BE BASED UPON DATA PROVIDED BY OTHERS AND MAY NOT HAVE BEEN VERIFIED BY EITHER AS-CONSTRUCTED DRAWINGS OR AN ONTARIO LAND SURVEYOR. THE CITY OF NORTH BAY CANNOT ACCEPT RESPONSIBILITY FOR ERRORS OR OMISSIONS ON ANY INFORMATION SHOWN HEREIN. FIELD VERIFICATION, LAND SURVEYS OR EXCAVATION (WITH CITY APPROVALS) MAY BE REQUIRED TO DETERMINE ACTUAL LOCATION OF ANY AND ALL UTILITIES OR PROPERTY LINES.
  - 3H:1V DITCH SIDE SLOPE TYPICAL. 2H:1V DITCH SIDE SLOPE TO ONLY BE USED LOCALLY WHERE EXISTING FEATURES (IE. TREES, UTILITY POLES, HYDRANTS) WARRANT IT.

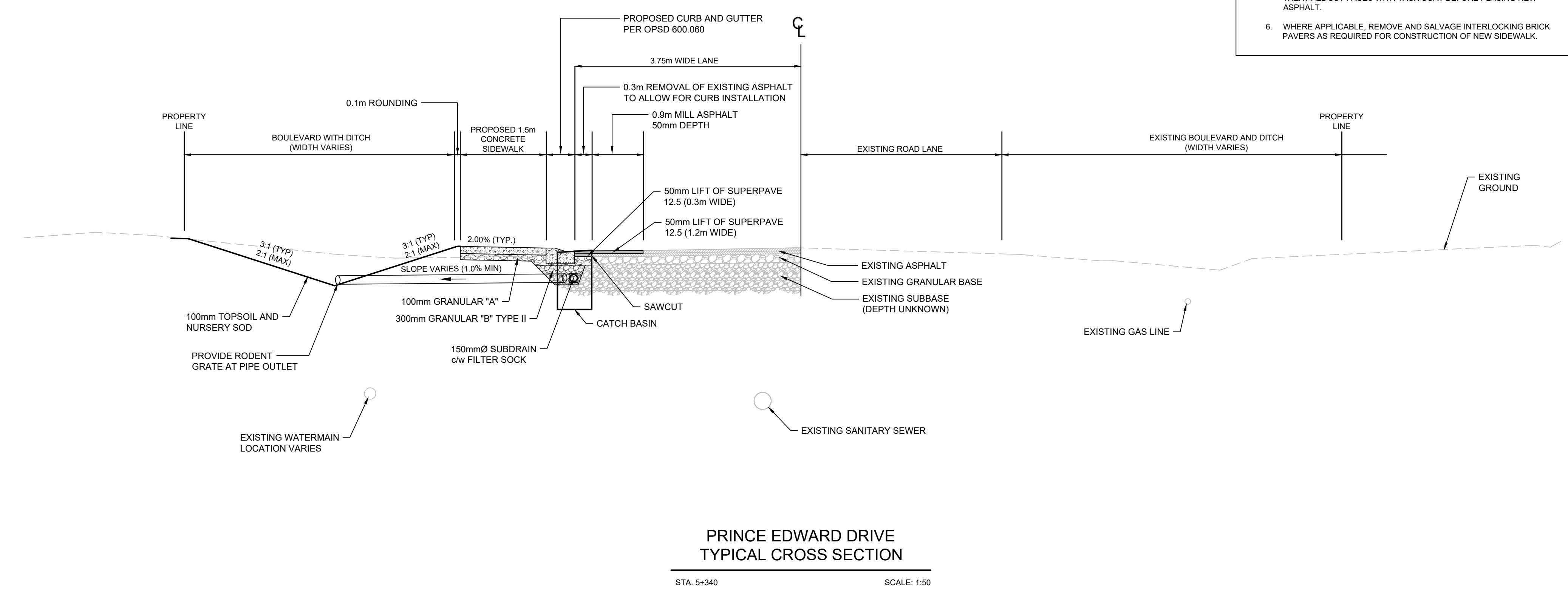

PRINCE EDWARD DRIVE  
TYPICAL CROSS SECTION

STA. 5+340 SCALE: 1:50

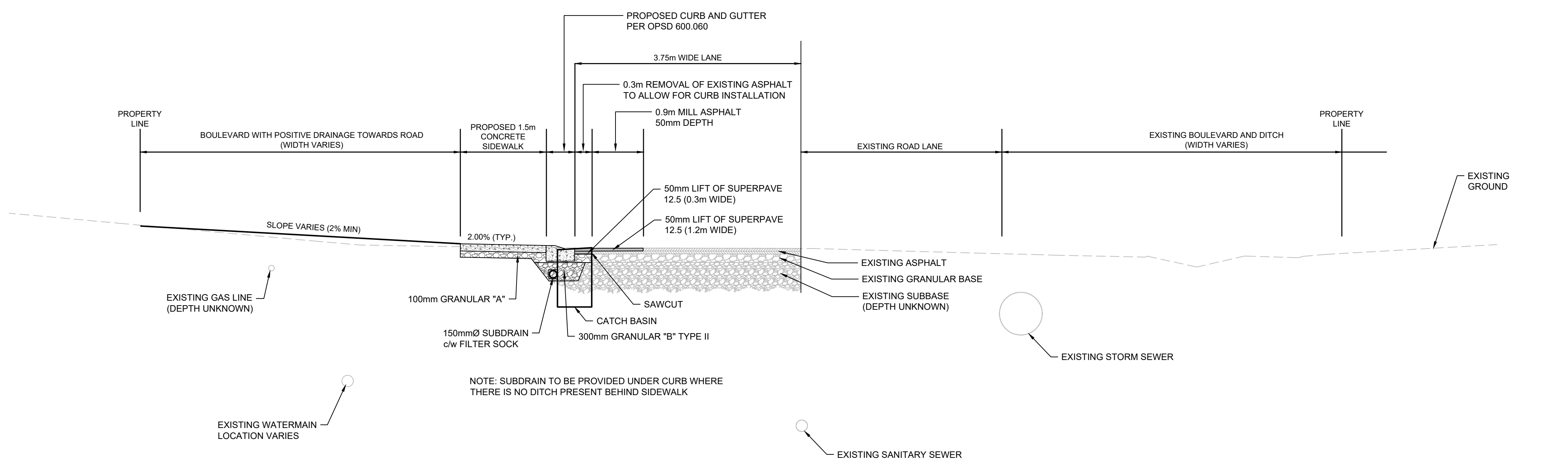

PRINCE EDWARD DRIVE  
TYPICAL CROSS SECTION

STA. 5+830 SCALE: 1:50

KEY PLAN

LEGEND

- 375mm Ø ST - STORM PIPE
- PROPOSED DITCH CENTERLINE
- PERFORATED PIPE
- CATCH BASIN AS PER OPSD 705.010
- STORM MAINTENANCE HOLE AS PER OPSD 701.010
- CATCH BASIN MAINTENANCE HOLE AS PER OPSD 701.010
- CURB & GUTTER WITH DEPRESSED CURB
- FULL DEPTH ROAD CUT WITH TOP LIFT MILLING
- CONCRETE SIDEWALK
- LIMIT OF GRADING
- TACTILE WALKING SURFACE INDICATOR (TWSI)
- EXISTING
  - BELL-BELL - EXISTING BELL
  - H-H - EXISTING HYDRO
  - G-G - EXISTING GAS
  - Ex. 200mm Ø SAN - EXISTING SANITARY PIPE
  - Ex. 300mm Ø W/M - EX. WATERMAIN & VALVE
  - LOT/CONCESSION LINES
  - EX. MAINTENANCE HOLE
  - EDGE OF PAVEMENT
  - HYDRO POLE/LIGHT
  - EXISTING DITCH

REVISIONS

No.	Date	By	Description
1	OCT 05 2021	AT	ISSUED FOR 30% DESIGN
2	DEC 23 2021	CL	ISSUED FOR 60% DESIGN
3	APR 29 2022	CL	ISSUED FOR 90% DESIGN
4	DEC 09 2022	CL	ISSUED FOR CLIENT REVIEW
5	DEC 16 2022	CL	ISSUED FOR TENDER
6	JAN 13 2023	CL	RE-ISSUED FOR TENDER



CITY OF NORTH BAY  
ICIP SIDEWALK  
PROGRAM

NEW CONSTRUCTION

PRINCE EDWARD DRIVE  
TYPICAL CROSS  
SECTIONS

Designer: A.Y. / C.B.	Checked by: D.L.
Date: 12/01/2021	Approved by: C.L.

Scale: 1:250	0 2.5 5 10
1:50	0 0.5 1 2

Drawing Number: <b>C13</b>	Drawing Set: <b>13 of 19</b>
-------------------------------	---------------------------------

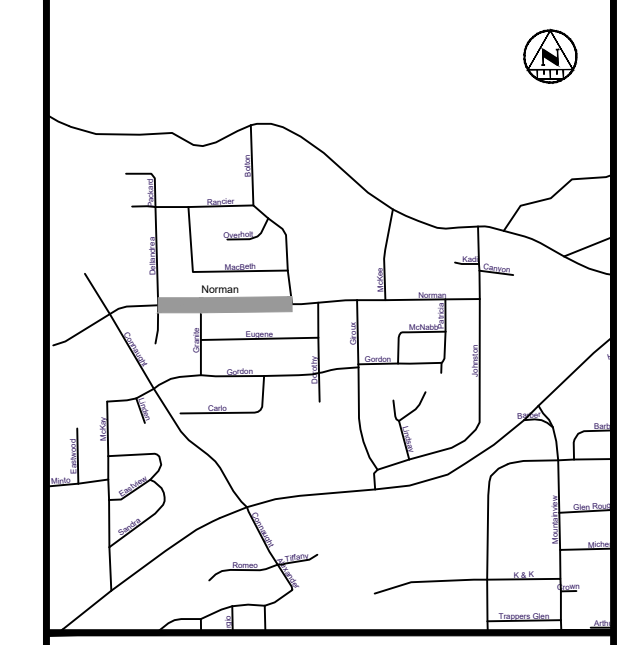
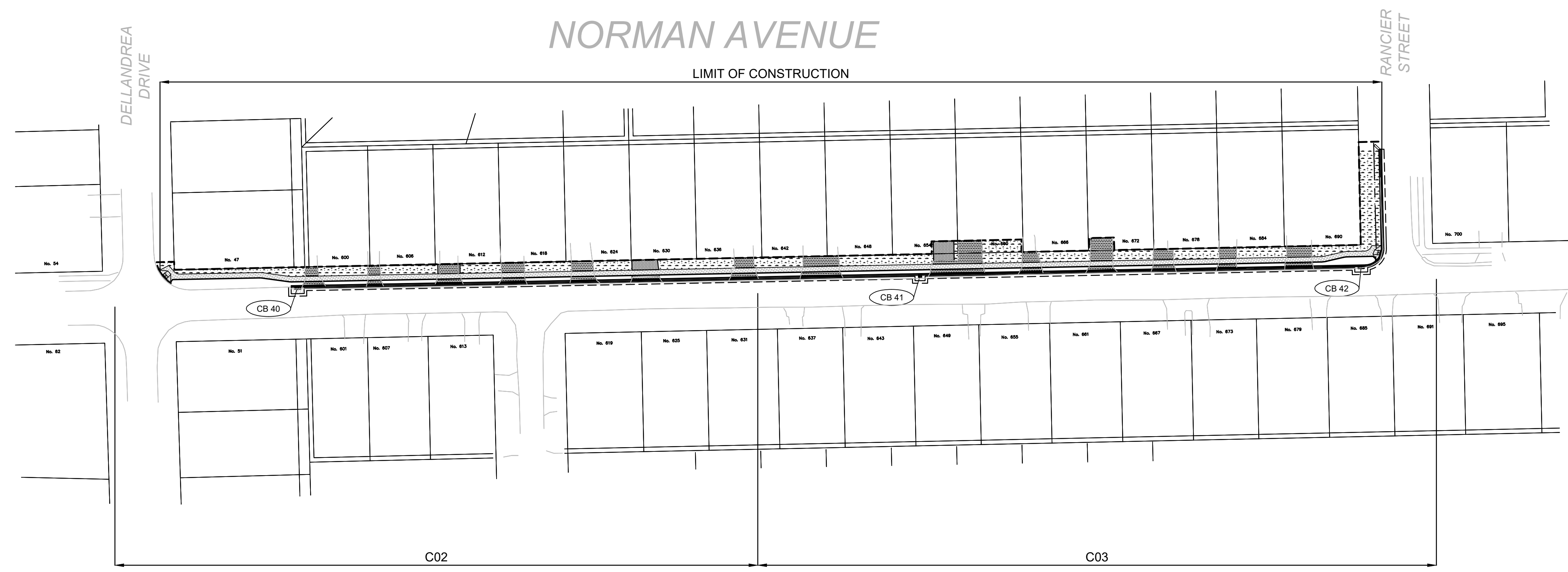
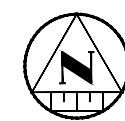

KEY PLAN

LEGEND

- PROPOSED**
- STORM PIPE
  - PROPOSED DITCH CENTERLINE
  - PERFORATED PIPE
  - CATCH BASIN AS PER OPSD 705.010
  - STORM MAINTENANCE HOLE AS PER OPSD 701.010
  - CATCH BASIN MAINTENANCE HOLE AS PER OPSD 701.010
  - CURB & GUTTER WITH DEPRESSED CURB
  - FULL DEPTH ROAD CUT WITH TOP LIFT MILLING
  - CONCRETE SIDEWALK
  - LIMIT OF GRADING
  - TACTILE WALKING SURFACE INDICATOR (TWSI)
- EXISTING**
- EXISTING BELL
  - EXISTING HYDRO
  - EXISTING GAS
  - EX. 200mm Ø SAN
  - EX. WATERMAIN & VALVE
  - LOT/CONCESSION LINES
  - EX. MAINTENANCE HOLE
  - EDGE OF PAVEMENT
  - HYDRO POLE/LIGHT
  - EXISTING DITCH

REVISIONS

No.	Date	By	Description
1	OCT 05 2021	AT	ISSUED FOR 30% DESIGN
2	DEC 23 2021	CL	ISSUED FOR 60% DESIGN
3	APR 29 2022	CL	ISSUED FOR 90% DESIGN
4	DEC 09 2022	CL	ISSUED FOR CLIENT REVIEW
5	DEC 16 2022	CL	ISSUED FOR TENDER
6	JAN 13 2023	CL	RE-ISSUED FOR TENDER

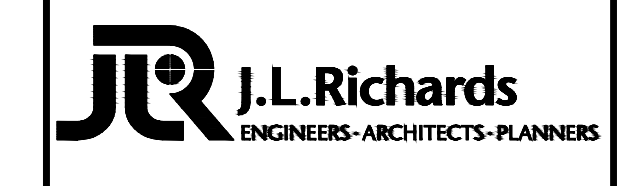

CITY OF NORTH BAY  
ICIP SIDEWALK  
PROGRAM

NEW CONSTRUCTION

Norman Avenue  
General Plan

Designer: A.Y. / C.B.	Checked by: D.L.
Date: 12/01/2021	Approved by: C.L.

Scale:  
1:750

Drawing Number: C15	Drawing Set: 15 of 19
------------------------	--------------------------

- CONSTRUCTION NOTES:**
- THE LOCATION OF THE UTILITIES IS APPROXIMATE ONLY. THE EXACT LOCATION SHOULD BE DETERMINED BY CONSULTING THE MUNICIPAL AUTHORITIES AND UTILITY COMPANIES CONCERNED. THE CONTRACTOR SHALL PROVE THE LOCATION OF UTILITIES AND SHALL BE RESPONSIBLE FOR ADEQUATE PROTECTION FROM DAMAGE.
  - ALL DIMENSIONS ARE IN METERS UNLESS OTHERWISE NOTED.
  - WITH THE EXCEPTION OF THE CITY OF NORTH BAY CONSTRUCTION SPECIFICATIONS & STANDARD DETAIL DRAWINGS REFERRED TO IN THIS CONTRACT, ONTARIO PROVINCIAL STANDARD DRAWINGS (OPSD) & STANDARD SPECIFICATIONS (OPSS) SHALL APPLY TO THIS CONTRACT.
  - ALL BASE MAPPING IS REFERENCED TO NORTH AMERICAN DATUM OF 1983 (NAD83)
  - ALL DISTURBED AREAS (SIDEWALK, PAVEMENT, CURB, SOD, ETC.) TO BE REINSTATED TO EXISTING CONDITIONS OR BETTER PER CITY OF NORTH BAY STANDARDS.
  - REFER TO GEOTECHNICAL REPORT. SOIL INFORMATION SHOWN IS NOT GUARANTEED AND CONTRACTORS ARE ADVISED TO COLLECT ADDITIONAL SOILS INFORMATION AS DEEMED NECESSARY.
  - CONTRACTOR TO ADVISE CONTRACT ADMINISTRATOR IMMEDIATELY OF ANY KNOWN CONFLICTS WITH TREES AND/OR EXISTING UTILITIES.
  - THE CONTRACTOR SHALL REMOVE, SALVAGE AND STORE IN SAFE AREA ALL EXISTING SIGNAGE IMPACTED BY WORK. REINSTATE ALL SIGNAGE AS PART OF WORK.
  - THE CONTRACTOR IS RESPONSIBLE FOR PROVIDING PROTECTION FOR ALL EXISTING UNDERGROUND AND ABOVE GROUND UTILITIES DURING CONSTRUCTION.
  - THE REINSTATEMENT DRAWINGS ARE APPROXIMATE ONLY AND ARE BASED ON SURVEY AND BASE MAPPING INFORMATION, WHICH MAY NOT INCLUDE ALL LANDSCAPING FEATURES AND DETAILS. SOME LANDSCAPING FEATURES MAY ALSO HAVE BEEN CHANGED BY HOMEOWNERS SINCE THE SURVEY WAS COMPLETED. THE CONTRACTOR SHALL BE SOLELY RESPONSIBLE FOR THE DOCUMENTS/PHOTOGRAPHING THE PRE-CONSTRUCTION CONDITIONS AND LANDSCAPING AT EACH PROPERTY PRIOR TO CARRYING OUT ANY REMOVALS. REINSTATEMENT SHALL MATCH THE PRE-CONSTRUCTION CONDITIONS UNLESS DIRECTED OTHERWISE BY THE CONTRACT ADMINISTRATOR.
  - EXISTING UNDERGROUND UTILITIES AND SERVICES DEPICTED ON THE DRAWINGS REPRESENT LOCATIONS IDENTIFIED ON THE CITY'S RECORD DRAWINGS. NOT ALL EXISTING UNDERGROUND UTILITIES AND SERVICES ARE DEPICTED ON THESE DRAWINGS. NO REPRESENTATION AS TO THE DEPTH OF ALL UTILITIES AND SERVICES IS MADE.
  - CONTRACTOR TO MAINTAIN ACCESS AT ALL TIMES TO ALL MHS, VALVE BOXES AND VALVE CHAMBERS.
  - CONTRACTOR SHALL EXCAVATE NEAR AND TEMPORARILY SUPPORT EXISTING UTILITIES IN ACCORDANCE WITH THEIR THIRD-PARTY REQUIREMENTS. THE USE OF HYDRO-EXCAVATION IN THE VICINITY OF EXCAVATION AND TREES IS INCLUSIVE TO THE EXCAVATION WORK.
  - CONTRACTOR TO CONFIRM ALL PROPOSED STORM AND DITCH OUTLET ELEVATIONS AT THE ONSET OF CONSTRUCTION. NOTIFY THE CA OF ANY DISCREPANCIES.

- CONSTRUCTION NOTES:**
- CONTRACTOR TO CONFIRM ALL GRADES AND TIE-IN POINTS PRIOR TO CONSTRUCTING NEW SIDEWALKS.
  - REINSTATE GRASSED AREAS WITH 100MM OF TOPSOIL AND No.1 NURSERY SOD.
  - PROTECT ALL UTILITIES INCLUDING UTILITY POLES.
  - ALL TREES ARE TO BE PROTECTED.
  - SAW CUT ASPHALT TO PROVIDE CLEAN LINES PRIOR TO REINSTATEMENT. PROVIDE 300MM WIDE STEP JOINT (400MM DEEP). TREAT ALL CUT FACES WITH TACK COAT BEFORE PLACING NEW ASPHALT.
  - WHERE APPLICABLE, REMOVE AND SALVAGE INTERLOCKING BRICK PAVERS AS REQUIRED FOR CONSTRUCTION OF NEW SIDEWALK.
  - ASPHALT DRIVEWAY REINSTATEMENT TO BE MINIMUM:
    - 250MM THICK GRANULAR 'A'
    - 50MM THICK HL3F MIX WITH PGAC - 58-34
  - GRANULAR DRIVEWAY REINSTATEMENT TO BE MINIMUM 250MM GRANULAR 'A'.
  - THE UTILITIES INFORMATION CONTAINED ON THIS DRAWING MAY BE BASED UPON DATA PROVIDED BY OTHERS AND MAY NOT HAVE BEEN VERIFIED BY EITHER AS-CONSTRUCTED DRAWINGS OR AN ONTARIO LAND SURVEYOR. THE CITY OF NORTH BAY CANNOT ACCEPT RESPONSIBILITY FOR ERRORS OR OMISSIONS ON ANY INFORMATION SHOWN HEREIN. FIELD VERIFICATION, LAND SURVEYS OR EXCAVATION (WITH CITY APPROVALS) MAY BE REQUIRED TO DETERMINE ACTUAL LOCATION OF ANY AND ALL UTILITIES OR PROPERTY LINES.
  - 3H:1V DITCH SIDE SLOPE TYPICAL. 2H:1V DITCH SIDE SLOPE TO ONLY BE USED LOCALLY WHERE EXISTING FEATURES (IE. TREES, UTILITY POLES, HYDRANTS) WARRANT IT.

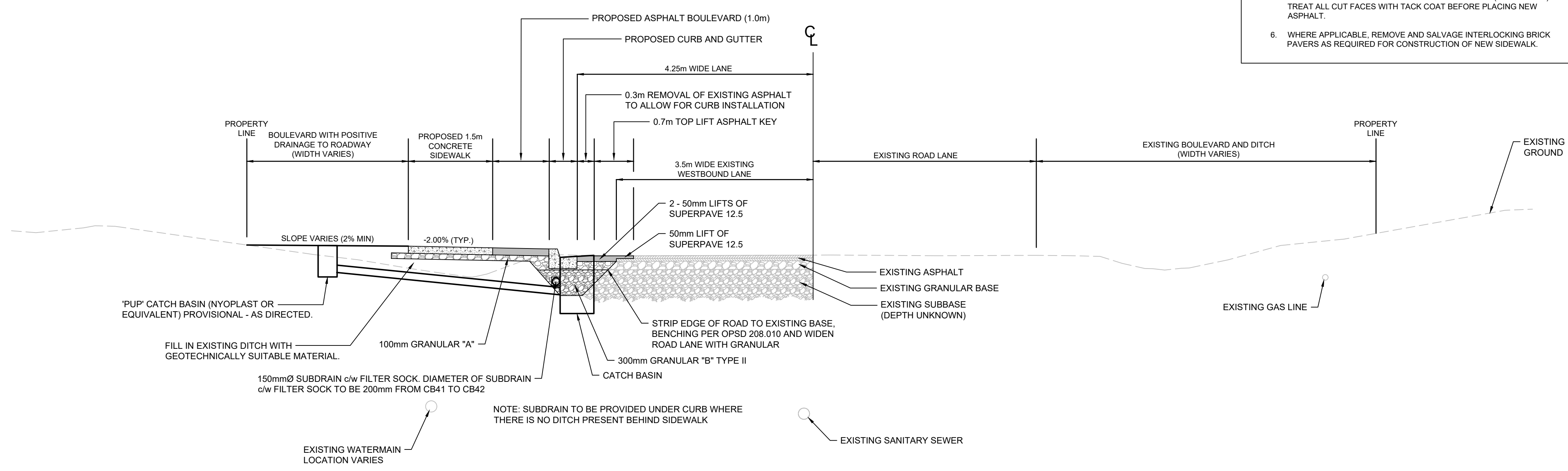

**NORMAN AVENUE  
TYPICAL CROSS SECTION**

STA. 6+330 SCALE: 1:50

**KEY PLAN**

**LEGEND**

- PROPOSED**
- 375mm Ø ST - STORM PIPE
  - PROPOSED DITCH CENTERLINE
  - PERFORATED PIPE
  - CATCH BASIN AS PER OPSD 705.010
  - STORM MAINTENANCE HOLE AS PER OPSD 701.010
  - CATCH BASIN MAINTENANCE HOLE AS PER OPSD 701.010
  - CURB & GUTTER WITH DEPRESSED CURB
  - FULL DEPTH ROAD CUT WITH TOP LIFT MILLING
  - CONCRETE SIDEWALK
  - LIMIT OF GRADING
  - TACTILE WALKING SURFACE INDICATOR (TWSI)
- EXISTING**
- BELL-BELL - EXISTING BELL
  - H-H - EXISTING HYDRO
  - G-G - EXISTING GAS
  - Ex. 200mm Ø SAN - EXISTING SANITARY PIPE
  - Ex. 300mm Ø W/M - EX. WATERMAIN & VALVE
  - LOT/CONCESSION LINES
  - EX. MAINTENANCE HOLE
  - EDGE OF PAVEMENT
  - HYDRO POLE/LIGHT
  - EXISTING DITCH

**REVISIONS**

No.	Date	By	Description
1	OCT 05 2021	AT	ISSUED FOR 30% DESIGN
2	DEC 23 2021	CL	ISSUED FOR 60% DESIGN
3	APR 29 2022	CL	ISSUED FOR 90% DESIGN
4	DEC 09 2022	CL	ISSUED FOR CLIENT REVIEW
5	DEC 16 2022	CL	ISSUED FOR TENDER
6	JAN 13 2023	CL	RE-ISSUED FOR TENDER



**CITY OF NORTH BAY  
ICIP SIDEWALK  
PROGRAM**

**NEW CONSTRUCTION**

**NORMAN AVENUE  
TYPICAL CROSS  
SECTIONS**

Designer: A.Y. / C.B. Checked by: D.L.  
Date: 12/01/2021 Approved by: C.L.

Scale: 1:250 2.5 0 5 10  
1:50 0.5 0 1 2

Drawing Number: **C18** Drawing Set: **18 of 19**